

DC Series

Deep Cycle series batteries are designed to have a large amount of stored current discharged between charging sessions, with very heavy non-porous battery plates to withstand repeated major discharging and charging cycle(deep cycle). The Deep-cycle batteries uses a different chemistry for the plates active paste material, and a slightly stronger electrolyte than normal battery electrolyte, which allows for a much longer life in deep cycle

BAT-LEADD-12V35AH-WL

(12V35Ah/10hr)

Application

- E-Bike
- Alarm System
- Cable Television
- Power tools
- Emergency Power System
- Security System
- Golf Cars
- Medical Equipment
- Solar and Wind Power System
- Communication Equipment
- Control Equipment
- Toys



General Features

- Sealed and maintenance free operation.
- Non-Spillable construction design.
- ABS containers and covers optional.
- Safety valve installation for explosion proof .
- High quality and high reliability.
- Exceptional deep discharge recovery performance.
- Low self discharge characteristic.
- Flexibility design for multiple install positions.

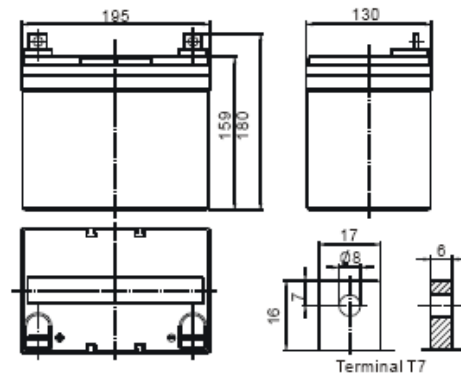

CONSTRUCTION

Component	Positive plate	Negative plate	Container	Cover	Safety valve	Terminal	Separator	Electrolyte
Raw material	Lead dioxide	Lead	ABS	ABS	Rubber	Copper	Fiberglass	Sulfuric acid

TECHNOLOGY PARAMETER

Battery model	DC12350			
Designed Cycle Life	>350 Cycles @ -0.5CA to 9.6V			
Capacity (25°C)	20hR(1.79A, 10.5V)	10hR(3.5A, 10.5V)	5hR(5.91A, 10.5V)	1hR(22.6A, 9.60V)
	35.8Ah	35.0Ah	29.55Ah	22.6Ah
Dimensions	Length	Width	Height	Total Height
	195±2mm	130±2mm	159±2mm	180±2mm
Approx. weight (±5%)	11.2 Kg (24.69 lbs)			
Internal resistance	Full charged at 25°C: 9mOhms			
Self discharge	3% of capacity declined per month at 25°C(average)			
Capacity Affected (by Temp. (20HR))	40 °C	25 °C	0 °C	-15 °C
	102%	100%	85%	65%
Charge Voltage (25°C)	Cycle use		Float use	
	14.4-14.7V(-30mV/°C), max. Current: 10.5A		13.5-13.8V(-20mV/°C)	

BAT-LEADD-12V35AH-WL (12V35Ah/10hr)

Constant current discharge ratings-amperes at 25°C

End Point Volts/Cell	5min	10min	15min	30min	1h	3h	5h	10h	20h
1.60V	110.73	84.00	63.64	37.35	21.51	9.42	6.17	3.61	1.85
1.65V	105.00	80.18	60.65	36.65	20.68	9.16	5.99	3.58	1.83
1.70V	99.27	75.73	57.53	36.02	19.92	8.85	5.82	3.54	1.82
1.75V	92.91	71.27	54.41	35.32	19.09	8.46	5.66	3.50	1.79
1.80V	86.55	67.45	51.29	34.62	18.33	8.08	5.49	3.50	1.78

Constant power discharge ratings-watts at 25°C

End Point Volts/Cell	5min	10min	15min	30min	1h	3h	5h	10h	20h
1.60V	199.8	151.5	115.8	68.09	39.52	17.50	11.45	6.75	3.48
1.65V	188.4	143.8	110.1	66.82	37.86	16.80	11.07	6.68	3.43
1.70V	176.3	134.9	103.7	64.91	36.21	16.16	10.69	6.55	3.39
1.75V	164.2	126.6	97.36	63.64	34.62	15.40	10.37	6.43	3.32
1.80V	152.7	119.0	91.64	61.92	32.96	14.64	9.99	6.36	3.27

